

knog.

Blinder MINI

QUICKSTART GUIDE

THE MINI FAMILY



DOT



NINER



CHIPPY

The Blinder Mini range is available in front and rear lights.

KNOG.COM.AU

RECHARGE BEFORE FIRST USE



USB Plug



USB Plug

INTERFACE

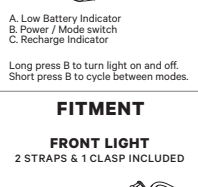

A. Low Battery Indicator

B. Power / Mode switch

C. Recharge Indicator

Long press B to turn light on and off.
Short press B to cycle between modes.

FITMENT

FRONT LIGHT

2 STRAPS & 1 CLASP INCLUDED

1. SML: Ø 22-27MM
 2. MED: Ø 27-32MM
- 

REAR LIGHT

3 STRAPS & 1 CLASP INCLUDED

1. SML: Ø 22-27MM
 2. MED: Ø 27-32MM
 3. LRG: Ø 32+MM*
- 

* Suitable for most aero posts

INTERCHANGEABLE STRAP



Stretch strap to fit clasp



Place strap end over hook



Pull strap toward the light body

MOUNTING

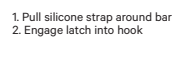

1. Pull silicone strap around bar

2. Engage latch into hook

WARRANTY INFORMATION

2 year warranty on materials and workmanship.

6 months battery warranty against manufacturing defects only. Not including battery deterioration.

STORAGE MODE

Light can be placed in storage mode if not used for a long time.

1. Charge light
2. Turn on - select flash mode.
3. Turn off
4. Hold button for 5 sec until main LED in on steady.
5. Wait for light to turn off automatically when battery is at correct level of storage. Main LED will flash slowly 3 times when storage mode exists.